



Detailed instruction manual available to download on our website:
www.ddgro.eu/en/decking-pedestals



DECKING PEDESTALS

For wooden or composite terraces

QUICK START MANUAL

HEIGHT RANGE:

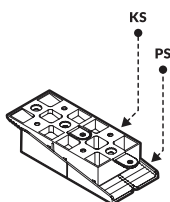

S from 15 mm to 35 mm

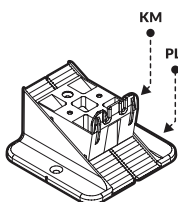

M from 35 mm to 65 mm

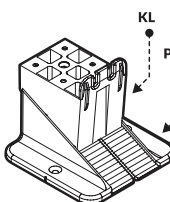

L from 65 mm to 95 mm

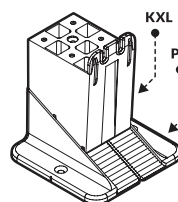

XL from 95 mm to 125 mm

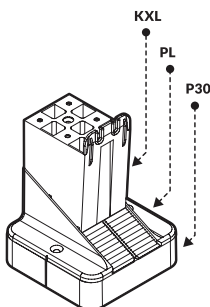

XL1 from 125 mm to 155 mm

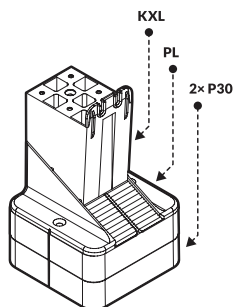

XL2 from 155 mm to 185 mm

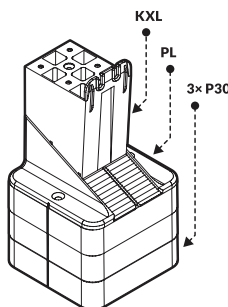

XL3 from 185 mm to 215 mm

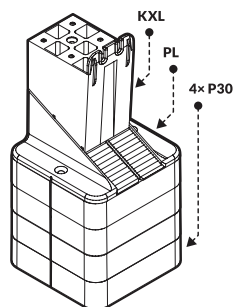

XL4 from 215 mm to 245 mm

PEDESTAL HEIGHT REGULATION:

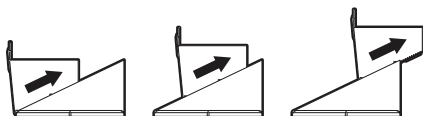

JOIST / BEAM PLACEMENT:

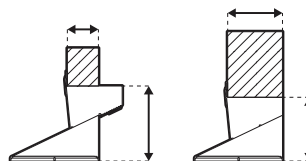

DECK-DRY Polska Sp. z o.o.
 RAPTOR

www.ddgro.eu
sales@ddgro.eu



SYSTEM ELEMENTS:



PS
Base S

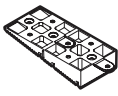

KS
Wedge S

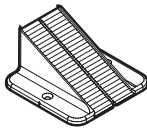

PL
Base L



KM
Wedge M



KL
Wedge L

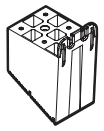

KXL
Wedge XL

ADDITIONAL ACCESSORIES:

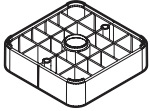

P30
Raiser 30 mm



PO
Protection pad

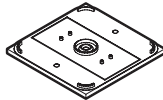

PA
Acoustic pad

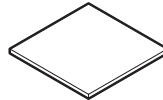

PG
Rubber pad



KN
Slope corrector

HOW TO SPLIT WEDGE S (for height regulation from 15 mm):

Wedge S can be splitted to two parts.

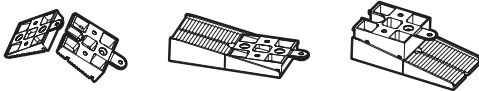

ADDITIONAL ACCESSORIES DEPEND ON TERRACE BASE SURFACE:

a) Solid surface without slope (concrete, wood, stone etc.) do not need any additional accessories. Acoustic pad **PA** can be used optionally.

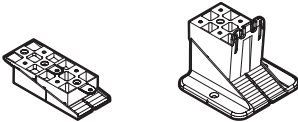

b) Sensitive surface as asphalt roofing, water membrane, XPS need to use protection pad **PO**.

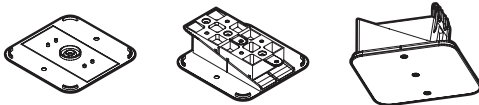

c) Sloped surface may need to use a slope corrector **KN**. To have additional protection for sensitive surface is recommended to use rubber pad **PG** with slope corrector.

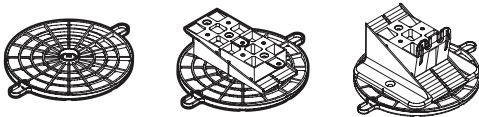

d) Surface that allows fixing pedestals can be done with hole openings on the pedestals.

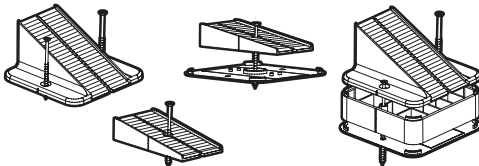

HOW TO CONNECT PEDESTAL WEDGE WITH THE BASE:

After setting desired height permanent fixing with a screw is possible. Use screw with hole opening in the wedge top.

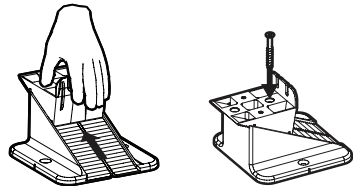

FIXING JOIST TO THE PEDESTAL:

We recommend to fix joist to the pedestals with using adapter lugs in the pedestal wedges. Avoid placing joist which protrude beyond pedestal base.

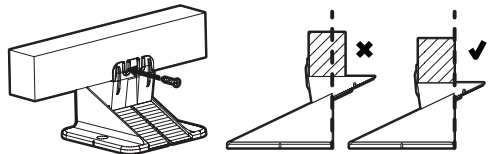

PEDESTAL DISPLACEMENT ALONG AND BETWEEN JOISTS:

The distance between pedestals needed to be specified with a manufacturer instruction manual of the joists (A) and planks (B). Most popular distance is 35 to 60 cm. You can raise stability of the whole construction with creating perpendicular joists connection as on the drawing below.

